

580 Buss Road

Cottage Grove, WI 53527

Call Today
(608) 401-4769

UNDER CONSTRUCTION



PRICED AT

\$438,900

Neighborhood: Shady Grove

3190 Drumlin Rdg Dr, Cottage Grove, WI

 3 Bedrooms

 2.5 Bathrooms

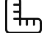
 1,801 Sq. Ft.

 2 Car Garage

Welcome to this stunning twin home offering style and functionality. A bright airy great room is the heart of the home with abundant natural light and a cozy fireplace ideal for relaxing evenings. The sunny kitchen is a dream for entertaining, with quartz countertops, an extra-large island, ample cabinetry, and large pantry. The sunny dinette overlooks a large deck. The main level also includes a convenient powder bath, and rear foyer with easy access to the 2-car garage. Upstairs, the spacious primary suite impresses with elegant box tray ceilings, a large walk-in closet, and a private en-suite bath. Two additional bedrooms, a full hall bath, and a second-floor laundry room complete the upper level, making everyday living effortless. This energy-efficient home checks all the boxes, Don't miss your chance to make it yours! Move in ready in August. Photos of similar model.

EXTERIOR SELECTIONS



HALL BATH

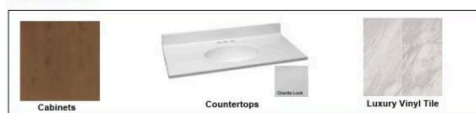

KITCHEN



PLUMBING FIXTURES



PRIMARY BATH



FINISHING TOUCHES



LIGHTING



The information, text, graphics and links provided herein are provided by Tim O'Brien Homes as a convenience to its customers. Tim O'Brien Homes does not guarantee the accuracy or completeness of the information, text, graphics, links and other items contained on this website or any other website. All prices, promotions and specifications are subject to change at any time without notice based on the discretion of Tim O'Brien Homes.

580 Buss Road

Cottage Grove, WI 53527

Call Today
(608) 401-4769



FIRST FLOOR

580 Buss Road

Cottage Grove, WI 53527

Call Today
(608) 401-4769

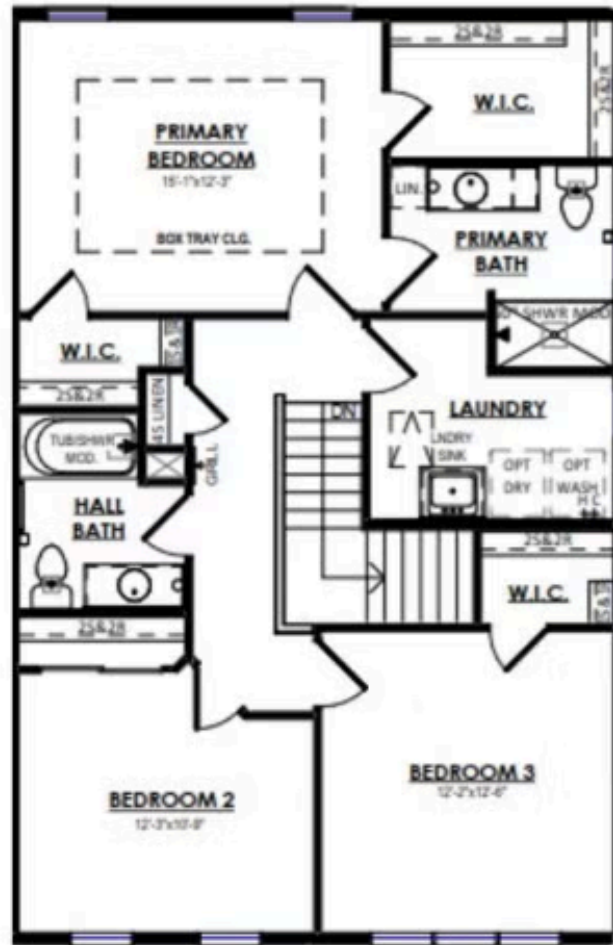

SECOND FLOOR