

6637 Redpoll Road

Middleton, WI 53562

TIM O'BRIEN
homes

Call Today
(608) 401-4769

UNDER CONSTRUCTION







PRICED AT

\$599,900

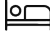
Neighborhood: Redtail Ridge
Belle Fontaine Rd, Middleton, WI

Home Plan: The Abbott

 3 Bedrooms
 2.5 Bathrooms
 2,029 Sq. Ft.
 2 Car Garage

Located in the highly sought-after Middleton School District, this stunning 3-bed, 2.5-bath home offers the perfect blend of comfort, space & functionality. Step into a warm & welcoming main level w/ spacious living area anchored by a charming fireplace perfect for relaxing evenings. The open layout flows seamlessly into the kitchen & dining area w/ room to gather. Double doors lead to a versatile flex room on the main level provides endless possibilities for a formal dining, office, craft or play room. Upstairs, find a generous primary suite w/ cathedral ceilings, private ensuite bath & walk-in closet, plus 2 additional bedrooms and a full bath. An egress window in the lower level allows potential for a future finished basement. Enjoy peaceful suburban living in this Middleton gem!

EXTERIOR SELECTIONS

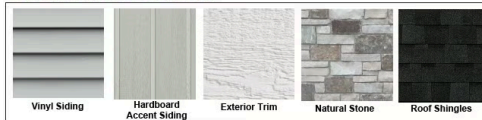

KITCHEN

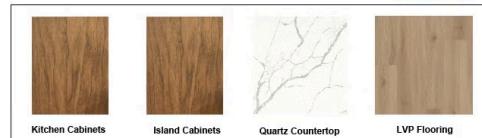

PRIMARY BATH



HALL BATH



PLUMBING FIXTURES



FINISHING TOUCHES



The information, text, graphics and links provided herein are provided by Tim O'Brien Homes as a convenience to its customers. Tim O'Brien Homes does not guarantee the accuracy or completeness of the information, text, graphics, links and other items contained on this website or any other website. All prices, promotions and specifications are subject to change at any time without notice based on the discretion of Tim O'Brien Homes.



6637 Redpoll Road

Middleton, WI 53562

TIM O'BRIEN
homes

Call Today
(608) 401-4769



FIRST FLOOR PLAN

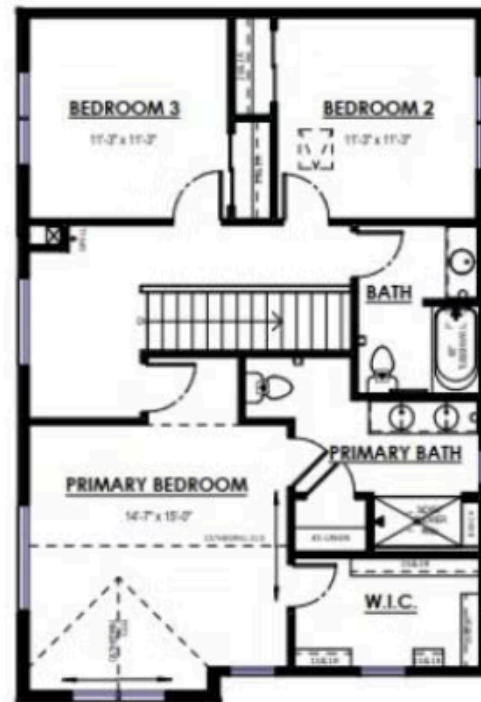

STANDARD SECOND FLOOR