

W261N6831 Prairie Haven Ct

Lisbon, WI 53089

TIM O'BRIEN
homes

Call Today
(262) 239-7342

UNDER CONSTRUCTION



PRICED AT

\$779,900

Neighborhood: Homestead Ridge
26231 Silver Spring Dr, Lisbon, WI

Home Plan: The Kendall

 3 Bedrooms

 2.5 Bathrooms

 2,264 Sq. Ft.

 3 Car Garage

The Kendall brings together comfortable main-level living, thoughtful design, and plenty of flexible space for today's lifestyles.

Step inside and you're welcomed by a bright foyer and a nearby flex room-perfect for a home office, playroom, or quiet retreat. The heart of the home opens into a spacious great room that flows directly into the kitchen and dinette, creating a warm and connected space for everyday living and entertaining. The kitchen includes a large island, walk-in pantry, and easy access to the dinette and backyard.

On one side of the home, you'll find two secondary bedrooms and a full bath, giving everyone their own space. On the opposite side, the private primary bedroom offers a peaceful escape with a large walk-in closet and a well-designed primary bath.

Convenience continues with a main-level laundry room located just steps from the primary suite, along with a powder room and a rear foyer that leads to the attached garage.

W261N6831 Prairie Haven Ct

Lisbon, WI 53089

Call Today
(262) 239-7342



First Floor

W261N6831 Prairie Haven Ct

Lisbon, WI 53089

Call Today
(262) 239-7342

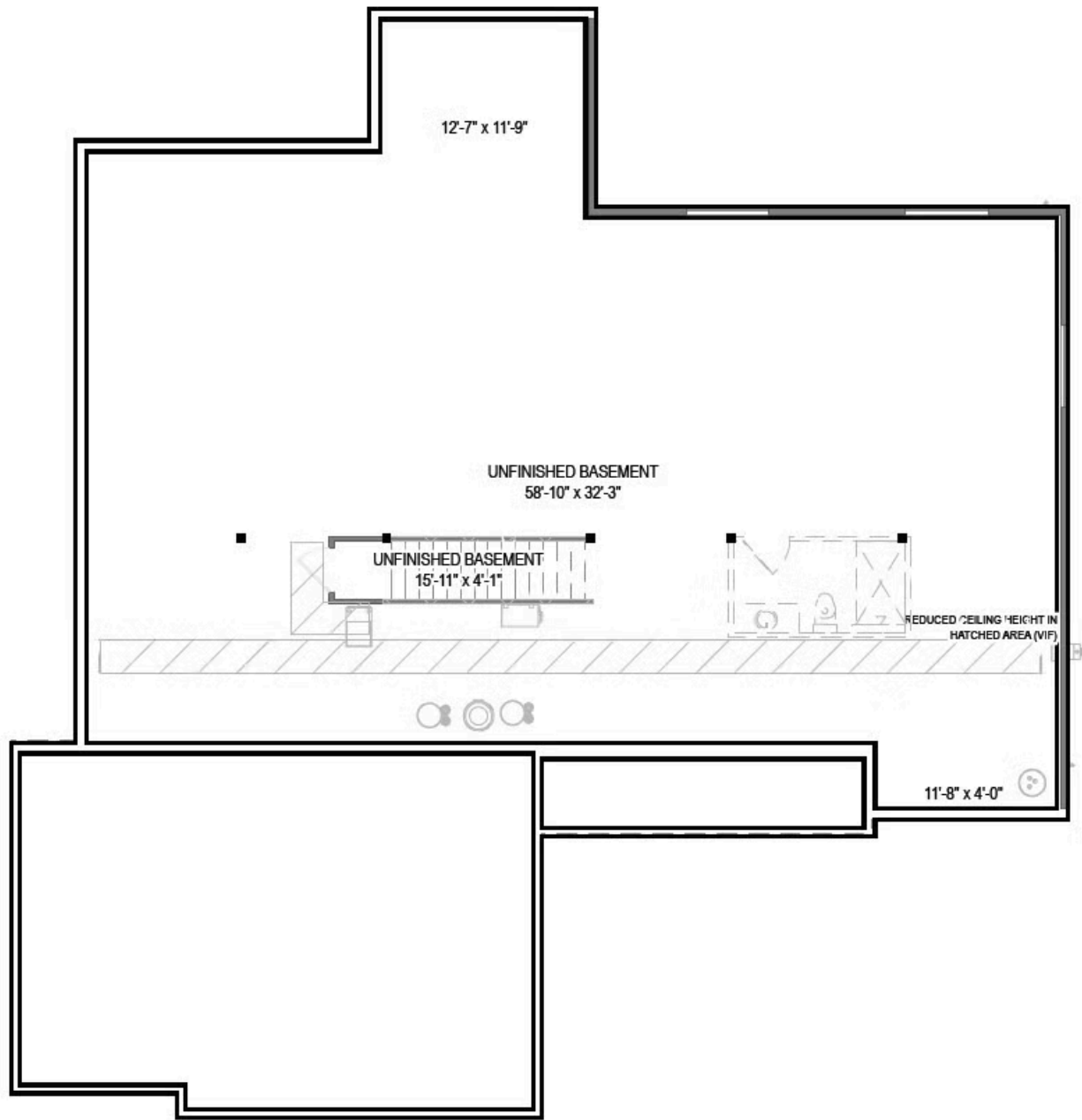

Basement