

W358N6309 Ennis Rd

Oconomowoc, WI 53066

TIM O'BRIEN
homes





Call Today
(262) 600-3769

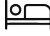

Call for Price

Neighborhood: The Snyder Farm
Snyder Way, Oconomowoc, WI

Home Plan: The Kendall

-  3 Bedrooms
-  3.5 Bathrooms
-  3,029 Sq. Ft.
-  3 Car Garage

We're excited to announce that we will be the 2026 St. Jude Dream Home® Showplace Builder for our 2026 MBA Parade Home at The Snyder Farm in Oconomowoc, WI! Through generous community involvement, the Showplace home is built by a local builder with donated labor, materials, and support from trade partners, vendors, and national sponsors. Once the home is completed, it is sold, and the net proceeds are donated directly to St. Jude Children's Research Hospital® to help support families, housing, treatment and more. To learn more about the 2026 Milwaukee St. Jude Dream Home® Showplace, please visit this [link](#).

The Kendall blends an open-concept layout with purposeful spaces that make everyday living feel easy. The main level centers around a spacious kitchen, dinette, and great room, with a screened-in deck just off the back for added living space. A private primary suite, two secondary bedrooms, and a flexible front room offer both comfort and versatility. The finished lower level extends the home with a large family room, full bath, and dedicated wine storage, while still leaving room for future expansion. A uniquely angled garage adds extra function and character to the overall design.

W358N6309 Ennis Rd

Oconomowoc, WI 53066

Call Today
(262) 600-3769

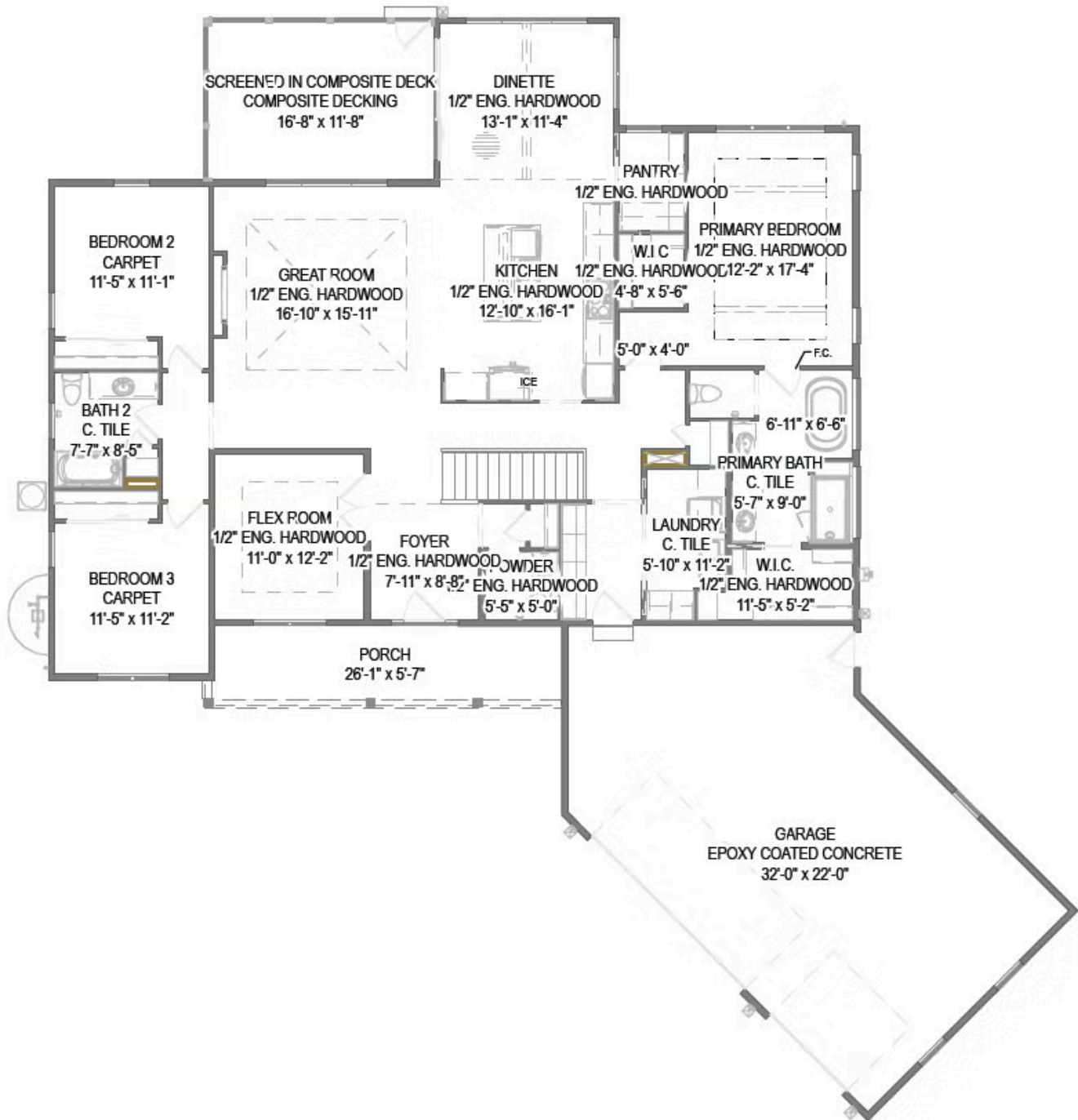

W358N6309 Ennis Rd

Oconomowoc, WI 53066

Call Today
(262) 600-3769

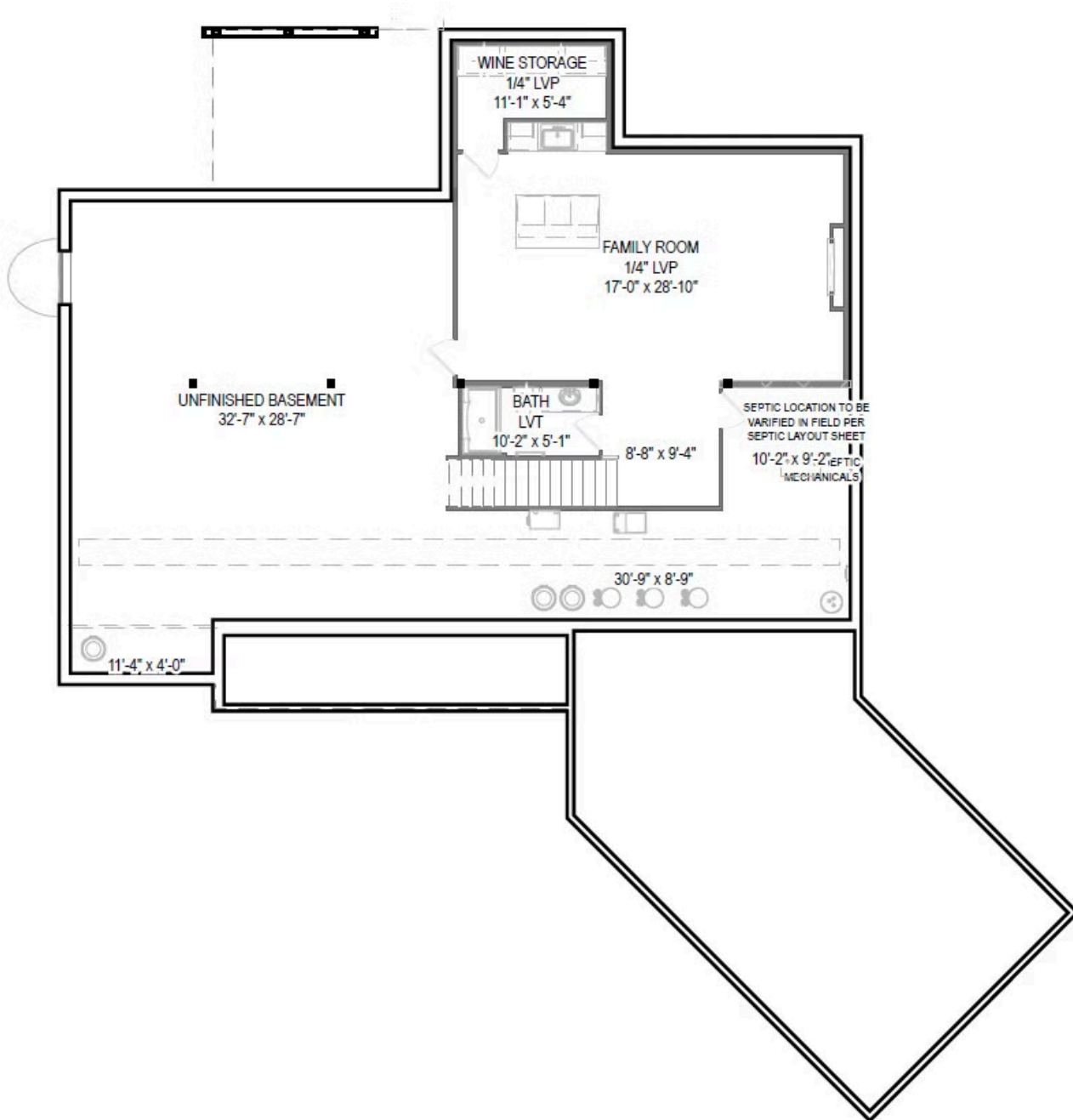

Basement